

Angle take-offs with mesh

ASV-45



Description

Angle take-off with mesh 45° is designed for terminating round ducts.

Example identification

Product code: **ASV-45 - aaa**

type _____
 Ød₁ _____

Dimensions

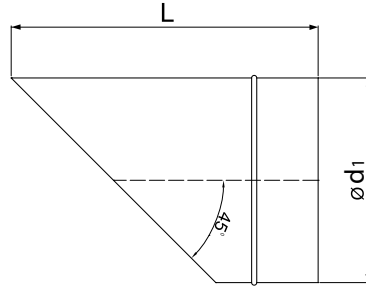

Ød ₁ [mm]	L [mm]	weight [kg]
125	198	0,24
140	210	0,29
150	221	0,32
160	230	0,35
180	250	0,41
200	270	0,48
224	294	0,57
250	373	0,98
280	402	1,16
315	438	1,39
355	482	1,77
400	547	2,28
450	627	3,59
500	677	4,23
560	737	5,04
630	807	6,10
710	948	10,00
800	1038	12,15
900	1136	14,66
1000	1251	17,95

* ASV – typically terminated with a male flange without gasket